

ZSA-E30DB
ZSA-E30DBS
ZSA-E30DS
ZSA-E30DW
ZSA-M90DB
ZSA-M90DBS
ZSA-M90DS
ZSA-M90DW

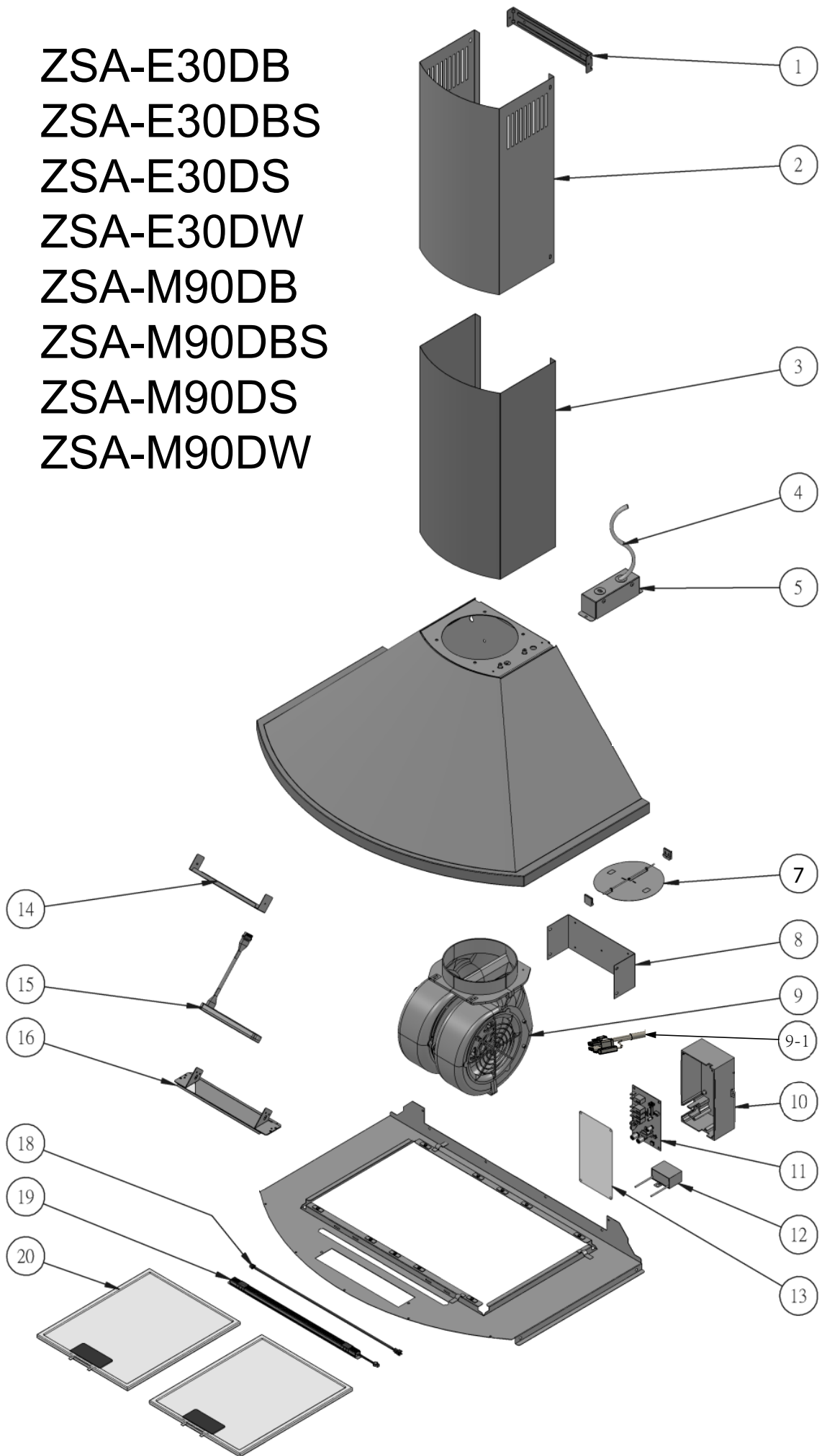

ZEPHYR

Savona

ZSA-E30D(B,BS,S,W), ZSA-M90D(B,BS,S,W)

Ref #	Part #	Description	Qty.
1	54110051	Bracket, Duct Cover	1
2	50050060	Upper Duct Cover, Black	1
2	50050175	Upper Duct Cover, Black SS	1
2	50050059	Upper Duct Cover, SS	1
2	50050151	Upper Duct Cover, White	1
3	50050062	Lower Duct Cover, Black	1
3	50050176	Lower Duct Cover, Black SS	1
3	50050061	Lower Duct Cover, SS	1
3	50050152	Lower Duct Cover, White	1
4	11030015	Wires, Electrical	1
5	56200081	Electrical Box	1
7	54060007	Damper, 6" Round	1
8	54140065	Bracket, Motor	1
9	12120043	Motor	1
9-1	11030171	Wiring, PCB to Motor, ZSA-D	1
10	54200020	Component Box	1
11	11010078	Control Board	1
12	12050021	Capacitor	1
13	56210067	Cover, Component Box	1
14	50100027	Switch Bracket	1
15	11000119	Switch Assembly (Blk SS, SS)	1
15	11000127	Switch Assembly (Black, White)	1
16	56200084	Switch Housing, Black	1
16	56200090	Switch Housing, Black SS	1
16	56200083	Switch Housing, SS	1
16	56200087	Switch Housing, White	1
18	11030113	Wiring, LED Strip	1
19	Z0B0042	LED Light Strip w/Cover, 9W	1
19-1	52150010	LED Light Strip Cover	1
20	50200011	Filter, Aluminum Mesh	2
21	05000118	Hardware Packet	1
21-1	01070015	Screw, M4 x 1 1/4	2
21-2	01090001	Screw, M6 x 1	3
21-3	01070006	Screw, M4 x 8mm	2
21-4	15000002	Wire Nut	3