

Use, Care and Installation Guide

Tempest I , II Stainless Steel Backsplash

AK0710 - 30"

AK0716 - 36"

AK0712 - 42"

AK0718 - 48"

AK0714 - 54"

LIST OF MATERIALS	_____	2
SPECIFICATION	_____	3
INSTALLATION	_____	4,5
CLEANING AND CONTACT INFORMATION	_____	6

Table of Contents

-
- 1 - Upper Section
 - 1 - Lower Section
 - 2 - Wire Racks
 - 1 - Hardware Packet
 - 2 - Retaining Clips
 - 4 - Hinge Clips
 - 6 - 7/16" Carriage Head Bolts
 - 8 - 5/8" Philips Head Wood Screw
 - 6 - Carriage Head Bolt Nuts

Note: If any parts are missing, please call
1-888-880-8368 for replacements.

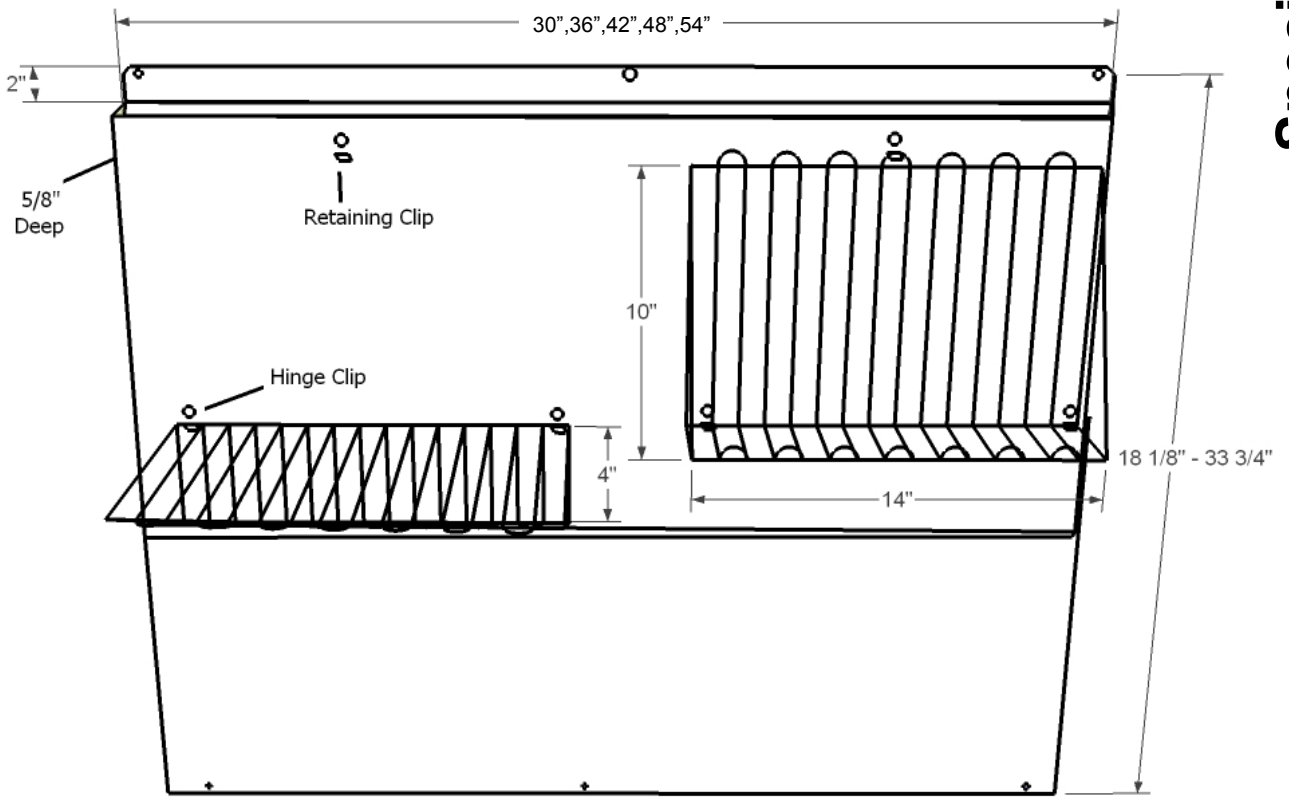

Specifications

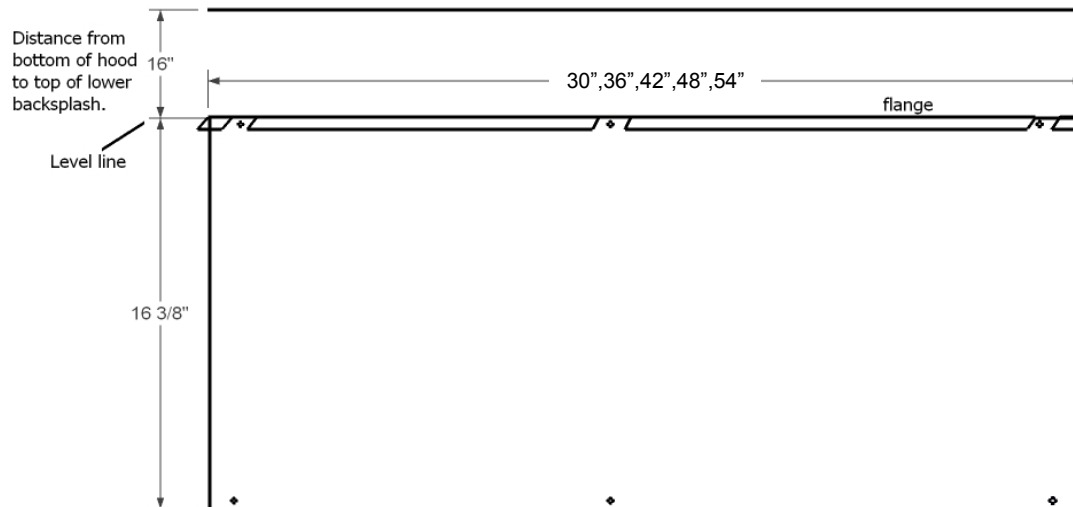

1. Mark a level line on the wall at 16" below bottom of hood.
2. Position the lower section of backsplash (flat part with flange on top) on the wall. Center it side to side and mark the top and bottom holes. Remove the lower section from the wall.
3. If installing onto drywall only and not onto studs, insert wall anchors (we recommend EZ anchors) into the marked holes. If installing onto studs, attach screws without EZ anchors.
4. Attach lower section of backsplash to wall with screws provided.
5. Position upper section of backsplash by engaging its flange with the lower section. Push up to fully engage flanges*, center it side to side and mark the location of the mounting holes. Remove the upper section from drywall and install wall anchors into marked holes.
- 5b. If hood is already installed, attach wall anchors into the (3) holes from inside the hood at the bottom. These are the holes which the upper section will line up with and mount to the wall.
6. Insert retaining clips and hinge clips to the upper section. The retaining clips go in the top top two openings and the hinge clips go in the bottom four openings. (see diagram, page 4) Fasten and tighten nuts to the clips on back of the upper section with the provided hardware.
7. Attach upper section to wall with screws provided. If hood is already installed, Insert the top 2" lip of the upper section behind the bottom of the hood and line up the holes with the (3) holes at the bottom of the hood. Insert screws into holes and fasten upper section to wall.

*note: in some installations, the flanges will not fully engage in the final install. This is fine since the weight of the upper section will rest against the bottom section.

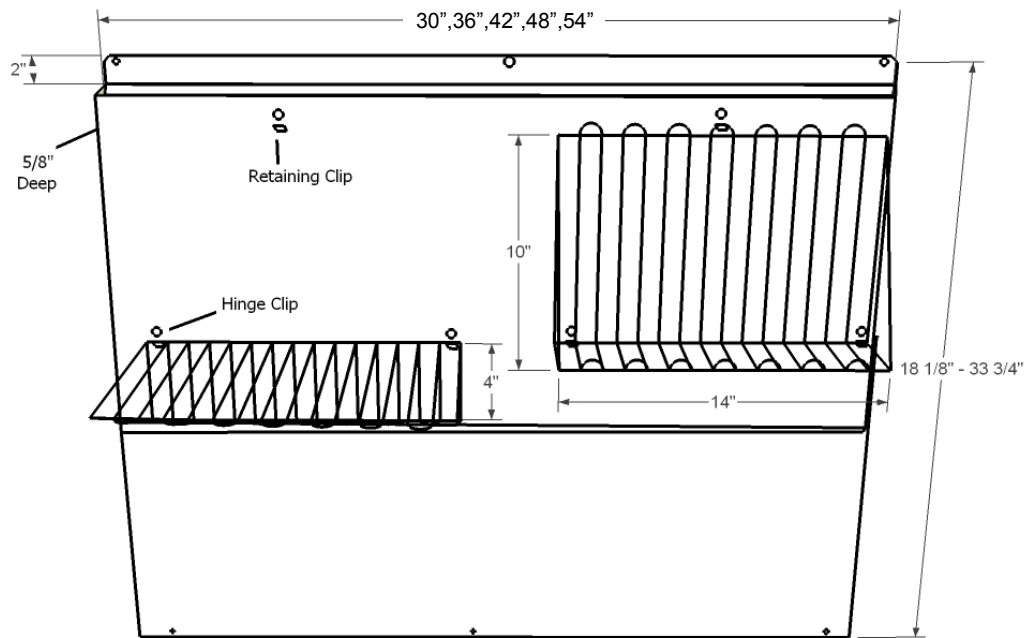

Installation

1. For the warming plate option; snap the wire shelves into hinge clips on the backsplash as shown in the left side shelf diagram.
2. For the spice rack option; attach shelf to hinge clips, as show in the right side shelf diagram, then rotate shelf upwards and secure with retaining clip.

Cleaning of the backsplash should be done frequently to preserve the life of the stainless steel. Cleaning should typically be done once or twice a month depending on your cooking habits.

When cleaning, use a non abrasive cleaner, do not use “orange” cleaner. Abrasive cleaners may scratch the surface and discolor the stainless steel. To clean the wire racks, soak them in soapy water. DO NOT place in a dishwasher as this may discolor the wire racks.

You may also polish the stainless steel by using stainless steel polish. Make sure when polishing to go along with the grain of the backsplash.

**Zephyr Ventilation
2277 Harbor Bay Parkway
Alameda, CA 94502
1-888-880-8368**